



□ □ □ □ □ □ □ □ □ □ □ □

ENVIRONMENTAL (construction solid about 80-100%)

CONVENIENT CONSTRUCTION
(traditional construction method)

WATER PROOF (0.6mm Polyurea=2mm Polyurethane)



**3rd GENERATION
POLYUREA BASIC**

WEATHER RESISTANCE (qvb2000h)

ENERGY CONSERVATION
(-5°Csolidify , primary film formation is 375um)

WEAR RESISTANCE (750g/500 times abrasion loss 30mg)
CORROSION RESISTANCE (salt fog resistance for 2000h)

□ □ □ □ □ □ □ □ □ □ □ □

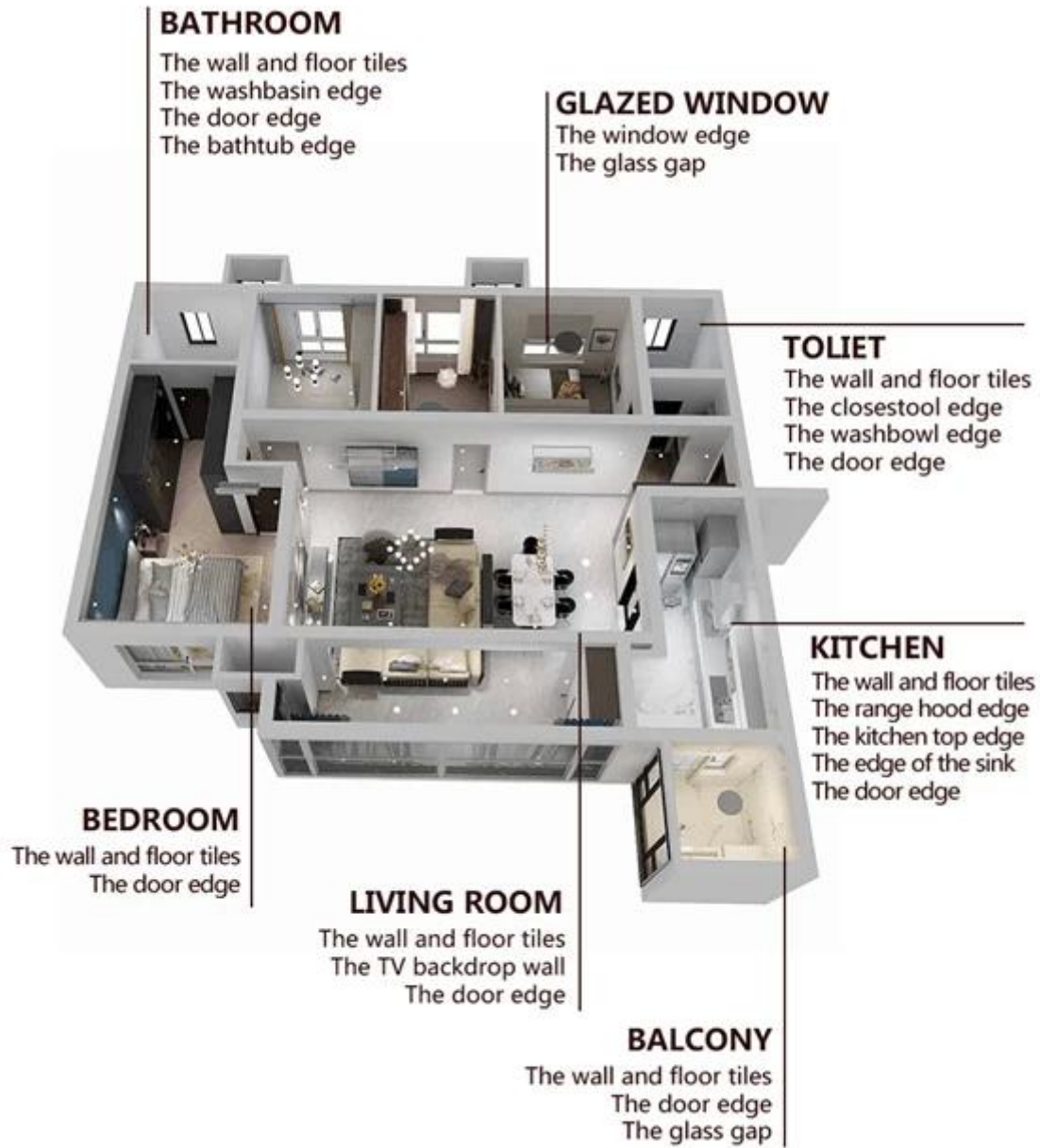

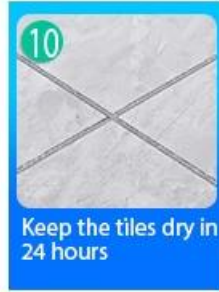
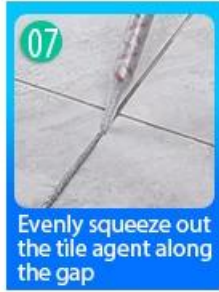

□□ □□ □□ □□



Two Component Caulking Gun



Cutter Knife

Pointing trowel

Brush

Forming Stick

Perching Knife

Masking Tape

Stainless Steel Ball

Cleaning Awl

□□ □□



□□ □□



□□ □□ □□



□□□ □□□



□□ □□ □□



□□ □□□



□□ □□ □□



□□ □□ □□



□□ □□ □□



□□ □□□

□□

