

□ □ □ □ □ □ □ □ □ □ □ □

**ENVIRONMENTAL** ( construction solid about 80-100%)

**CONVENIENT CONSTRUCTION**  
(traditional construction method)

**WATER PROOF** (0.6mm Polyurea=2mm Polyurethane)



**3<sup>rd</sup> GENERATION  
POLYUREA BASIC**

**WEATHER RESISTANCE** (qvb2000h)

**ENERGY CONSERVATION**  
( -5°Csolidify , primary film formation is 375um)

**WEAR RESISTANCE** (750g/500 times abrasion loss 30mg)  
**CORROSION RESISTANCE** (salt fog resistance for 2000h)

□ □ □ □ □ □ □ □ □ □ □ □

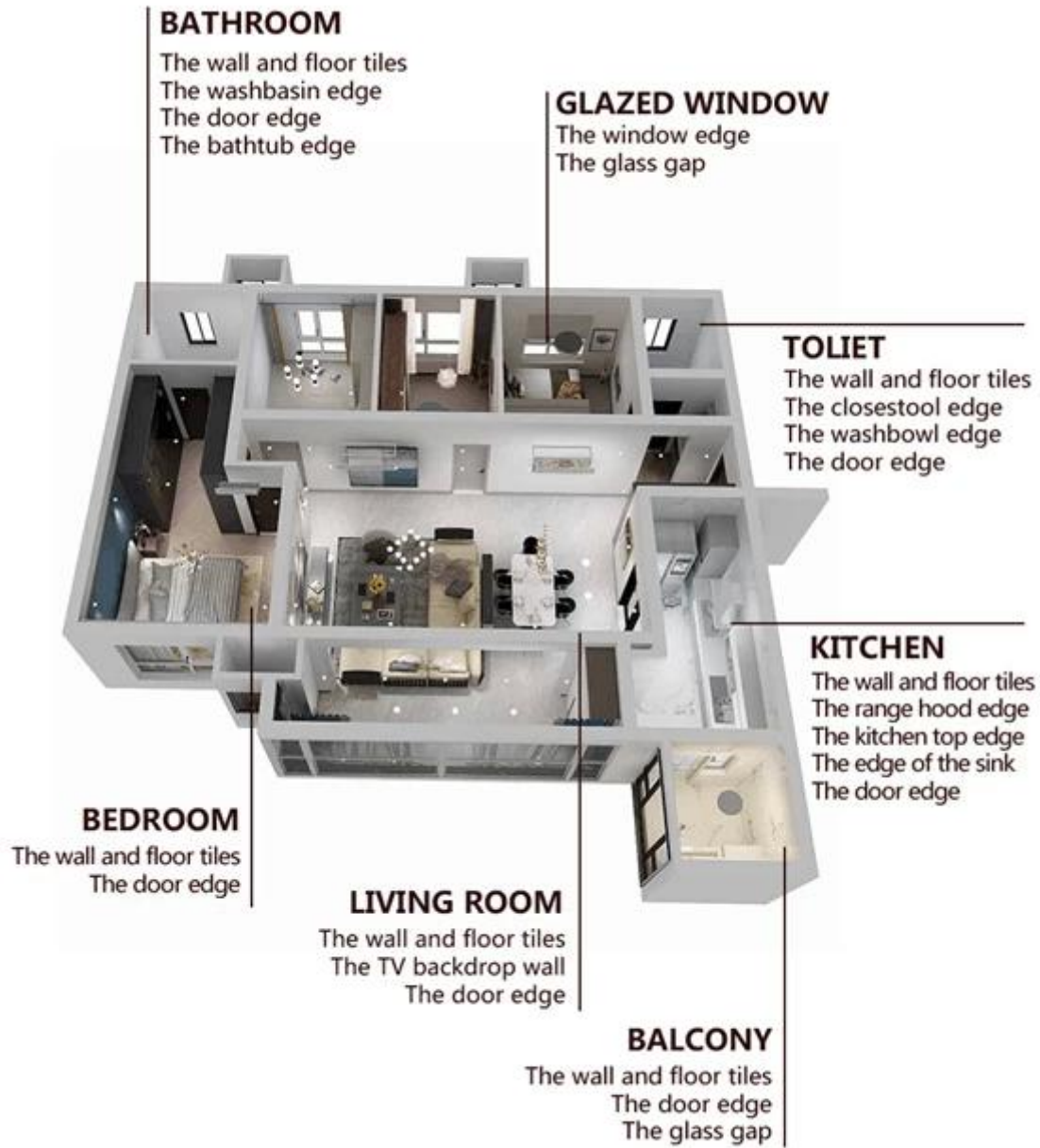



01 Clean the tiles and keep it dry



02 Polish with tile wax except the glazed tile



03 Open & Watch, both sides can extruded meanwhile



04 Screw on the nozzle, put on the grout gun



05 Inclined cut the top of the nozzle in 45°



06 Squeeze out 60-80cm long grout in the forepart



07 Evenly squeeze out the tile agent along the gap



08 Press the grout with professional glue-press tools



09 Don't touch in 2-4 hours and remove excess grout then.

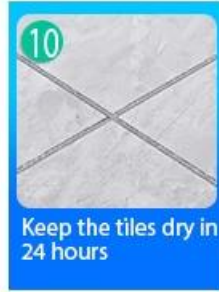

10 Keep the tiles dry in 24 hours

□□ □□ □□ □□



Two Component Caulking Gun



02 Cutter Knife



03 Pointing trowel



04 Brush



05 Forming Stick



06 Perching Knife



07 Masking Tape



08 Stainless Steel Ball



09 Cleaning Awl

□□ □□





□□ □□



□□ □□ □□



□□□ □□□



□□ □□ □□



□□ □□□



□□ □□ □□



□□ □□ □□



□□ □□ □□



□□ □□□

□□

