

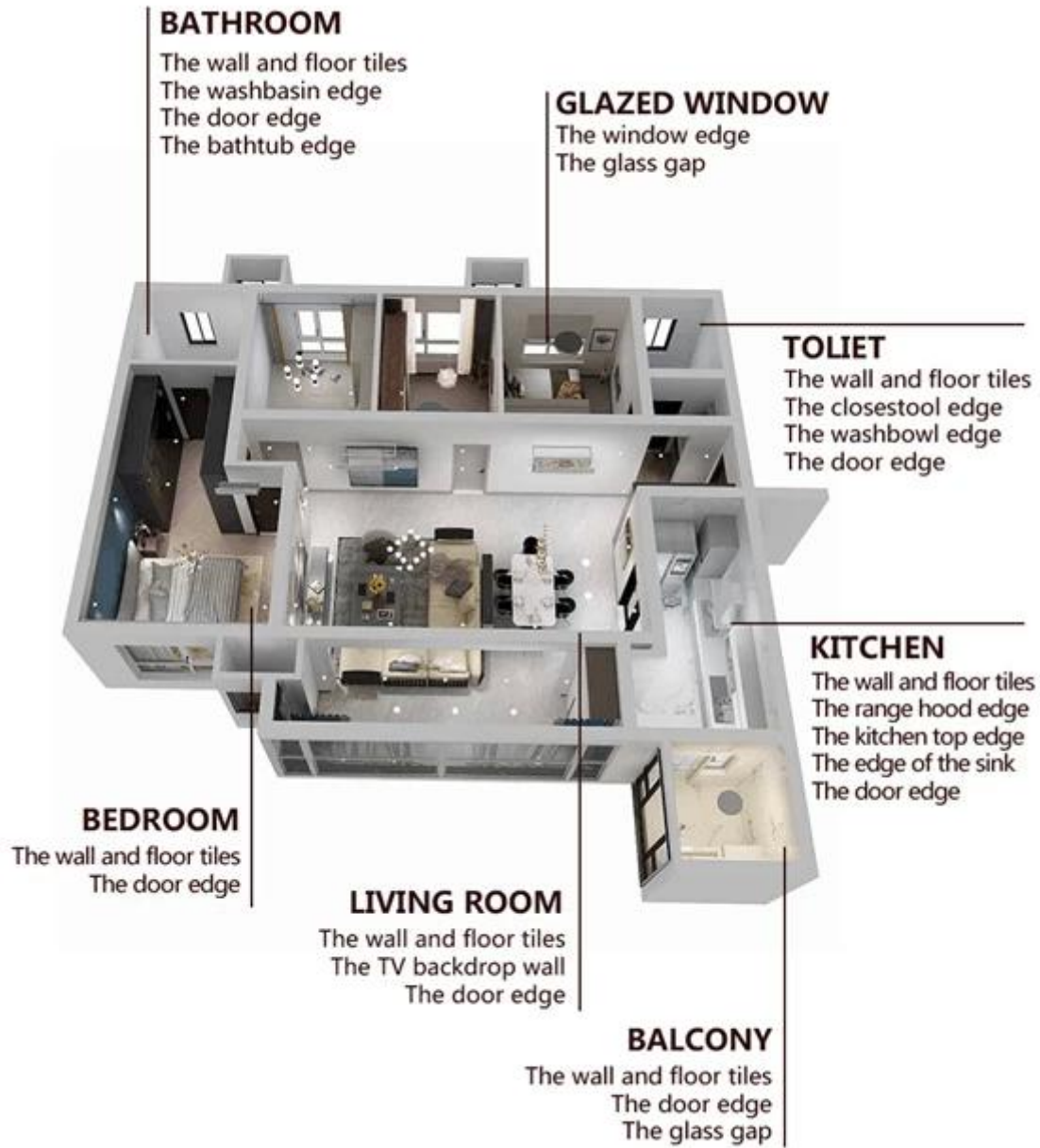



- Pure White
- Ivory
- Lemon Gold
- Pearl Gold
- Light Gold
- Lime Gold
- Amber Gold
- Nobility Gold
- Luxury Gold
- Shiny Gold
- Dazzle Gold
- Moonlight Silver
- Shiny Silver
- Dazzle Silver
- Light Gray
- Noble Gray
- Silver Gray
- Champaign Gold
- Bronze
- Rose Gold
- Coffee Brown
- Black Pearl

□□ □□ □ □□□ □□





01  
Clean the tiles and keep it dry



02  
Polish with tile wax except the glazed tile

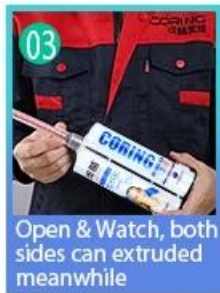

03  
Open & Watch, both sides can extruded meanwhile

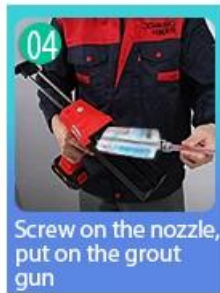

04  
Screw on the nozzle, put on the grout gun



05  
Inclined cut the top of the nozzle in 45°



06  
Squeeze out 60-80cm long grout in the forefront



07  
Evenly squeeze out the tile agent along the gap

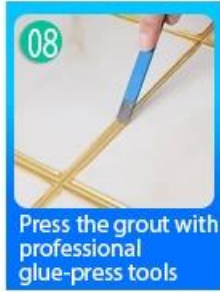

08  
Press the grout with professional glue-press tools



09  
Don't touch in 4-5 hours and remove excess grout then.

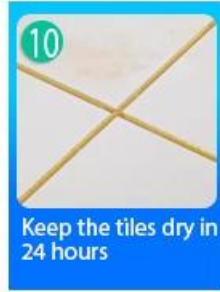

10  
Keep the tiles dry in 24 hours

□□ □□ □□ □□



Two Component Caulking Gun



02  
Cutter Knife



03  
Pointing trowel



04  
Brush



05  
Forming Stick



06  
Perching Knife



07  
Masking Tape



08  
Stainless Steel Ball



09  
Cleaning Awl

□□ □□



□□ □□



□□ □□ □□



□□□



□□ □□ □□



□□ □□□



□□ □□ □□



□□ □□□



□□ □□ □□



□□

□□

